



Test Posts Data Sheet

The **pml** range of Test / Monitoring Posts is available to suit all your testing and monitoring requirements

Standard M28 Type

A reinforced concrete 'hedgerow' Test Post of standard pattern supplied with four brass termination bolts and 'Foamex' face plates marked CP.

Alternative specialised internal terminal fittings are available to suit customer specified requirements.

Custom printed or stamped face plates are also available to suit customer specifications.

Unit weight : 50 kg

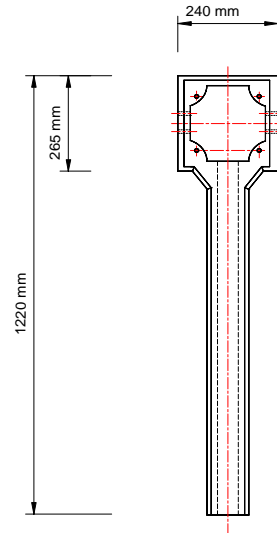

M28 - GRC Lightweight Pattern

Of lightweight design in glass reinforced concrete and offering ease of access for multiple cable entries.

Supplied with four brass termination bolts as standard but can additionally be supplied with integral terminal rail for up to six terminal blocks and space for the incorporation of resistors and shunts if desired.

The face plate size is interchangeable with the Standard M28.

Unit Weight : 12 kg

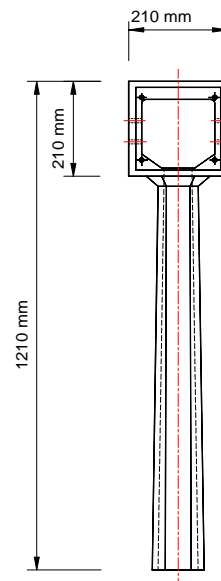

Pipeline Maintenance Limited

Cathodic Protection Engineering and Materials Supply
11 & 12 Merlin Park, Mildenhall,
Suffolk, IP28 7RD, UK
Tel: +44 (0) 1638 711955
Fax: +44 (0) 1638 711953

Data Sheet TP01 Rev 01

Page No 1 of 5

email: sales@pipelinemaintenance.co.uk
website: www.pipelinemaintenance.co.uk



Face Plates

Face plates are Custom made to suit individual customer requirements and can be supplied in a wide range of colours and lettering to suit the application.

Standard plates are in white and lettered **CP** in black.

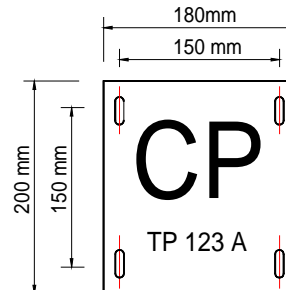

Model T-3

The Models T-3 is injection moulded using Lexan® polycarbonate plastics to ensure maximum strength and UV protection to guard against failure due to prolonged exposure to sunlight.

The T-3 is designed to survive in harsh climatic environments worldwide and come with a limited 25-year warranty. These unique test stations are designed for easy installation on either new or existing 3" PVC pipe risers and require no tools. Other features include our exclusive "Supergrip Top" making it easy to open the Test Station while wearing gloves, and the "Anti-spin" gasket, which prevents the possibility of the test stations "spinning" on the riser.

The T-3 is available from stock in eight colours and riser pipe in your choice of three colours, in stock as well. Model T-3 terminals come with standard 5 binding post configuration on its 11-hole terminal board.



Pipeline Maintenance Limited

Cathodic Protection Engineering and Materials Supply

11 & 12 Merlin Park, Mildenhall,
Suffolk, IP28 7RD, UK

Tel: +44 (0) 1638 711955

Fax: +44 (0) 1638 711953

Data Sheet TP01 Rev 01

Page No 2 of 5

email: sales@pipelinemaintenance.co.uk

website: www.pipelinemaintenance.co.uk



Transformer Rectifier & General Equipment Housing

A multi purpose Transformer Rectifier and Equipment Housing suitable for housing many types of equipment associated with Cathodic Protection and equally suitable for a multitude of other field installations.

The cover plate is a 4 mm thick aluminium plate with removable key to maintain security.

The back of the housing has a marine ply mounting panel bolted to it to facilitate equipment mounting.

Ample space is provided for cable access.

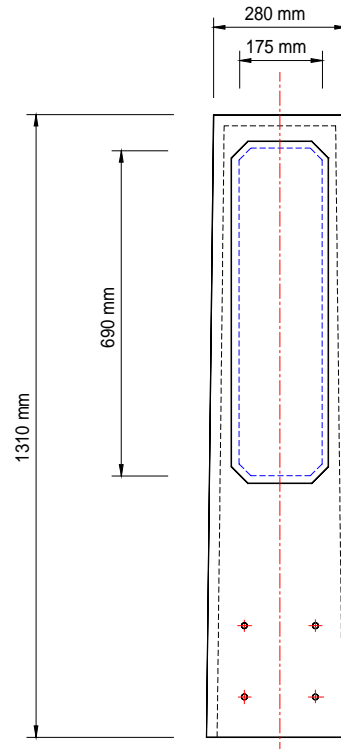

Order Key

Standard M28 Test Post

Lightweight M28 Test Post

Transformer Rectifier & General Equipment Housing

Model T-3 Polycarbonate test post (specify with or without riser)

Pipeline Maintenance Limited

Cathodic Protection Engineering and Materials Supply

11 & 12 Merlin Park, Mildenhall,
Suffolk, IP28 7RD, UK

Tel: +44 (0) 1638 711955

Fax: +44 (0) 1638 711953

Data Sheet TP01 Rev 01

Page No 3 of 5

email: sales@pipelinemaintenance.co.uk
website: www.pipelinemaintenance.co.uk



Middle Eastern Standard Test Posts

A variety of standard pattern tests posts specifically designed for installation in desert environments and manufactured from steel coated with white epoxy powder type 1173 - 6008 polyester after degreasing and phosphating.

"Top hats" and caps painted in epoxy orange polyester type EPOL 6050G.

All units supplied with captive sealed inspection covers with quick release entry for test purposes giving access to the six way thermal panel configured either standard or custom pattern as specified.

Type I	76mm dia x 1500mm long test post c/w quick release lift off cap.
Type II	82mm dia x 1500mm long surge diverter test post assembly c/w removable cap to reveal live side/dead side flange pillar terminal arrangement.
Type IIA	76mm dia x 1500mm long test post c/w large or small 'top hat' aerial km marker.

A full range of complementary cathodic protection equipment is available including:

- Test cables and lugs
- Thermit weld or pin braze cable pipe connection equipment
- Permanent reference electrodes
- Impressed and sacrificial anodes
- Transformer rectifiers

Services include:

- Resistivity Surveys
- Design Engineering and Drafting
- Site Supervision and Commissioning Manpower Supply
- Close Interval Potential Surveys

Pipeline Maintenance Limited

Cathodic Protection Engineering and Materials Supply
11 & 12 Merlin Park, Mildenhall,
Suffolk, IP28 7RD, UK
Tel: +44 (0) 1638 711955
Fax: +44 (0) 1638 711953

Data Sheet TP01 Rev 01

Page No 4 of 5

email: sales@pipelinemaintenance.co.uk
website: www.pipelinemaintenance.co.uk



Middle Eastern Standard Test Posts

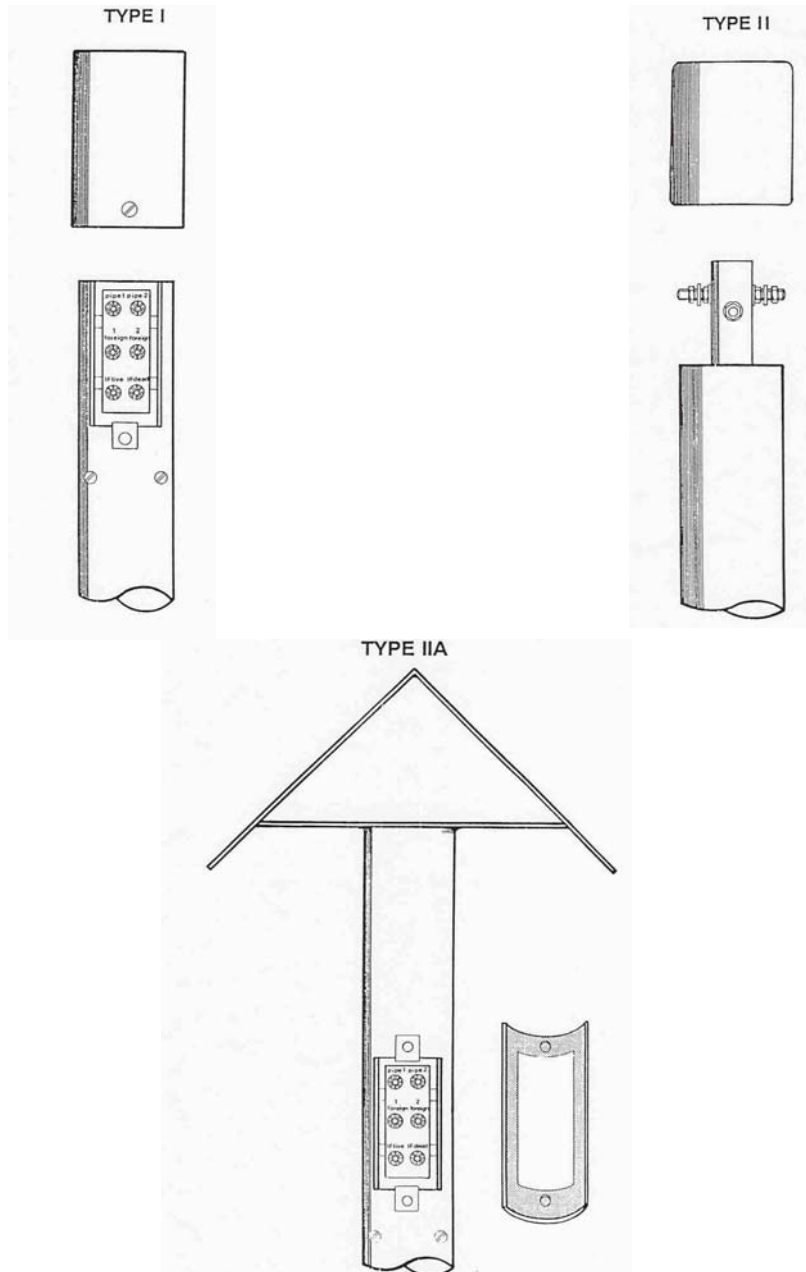

Pipeline Maintenance Limited

Cathodic Protection Engineering and Materials Supply

11 & 12 Merlin Park, Mildenhall,
Suffolk, IP28 7RD, UK

Tel: +44 (0) 1638 711955

Fax: +44 (0) 1638 711953

Data Sheet TP01 Rev 01

Page No 5 of 5

email: sales@pipelinemaintenance.co.uk

website: www.pipelinemaintenance.co.uk

